

## concrete and masonry accessories B-SEAL Installation Procedure

1. Set Formwork/Expansion Board and the top of it should be set 1/4 inch below the top of slab.
  2. Use stakes when necessary to make sure Formwork/Expansion Board is able to stay in place throughout installation procedure. Make sure there will be a 1/4 inch minimum clearance between bottom of B-SEAL & top of the stakes. See Figure A.
  3. Place B-SEAL on top of Formwork/Expansion Board. Make sure B-SEAL is completely against the Formwork/Expansion Board. See Figure B.
  4. Splice butt ends and factory fabrications using heating iron to weld ends together. Make sure ends are square.
  5. Every 18 inches use nails or staples on both sides to secure B-SEAL to the Formwork/Expansion Board below the embedment ribs. See Figure B.
  6. Place concrete and vibrate thoroughly to consolidate concrete around B-SEAL. See Figure C.
  7. Screed flush with top of B-SEAL. See Figure D.
- TOOLING NOT NECESSARY! DO NOT TOOL JOINT!**

### Fabrications & Butt Splicing

A

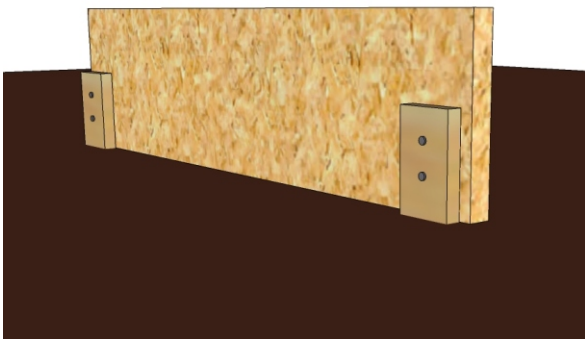

B

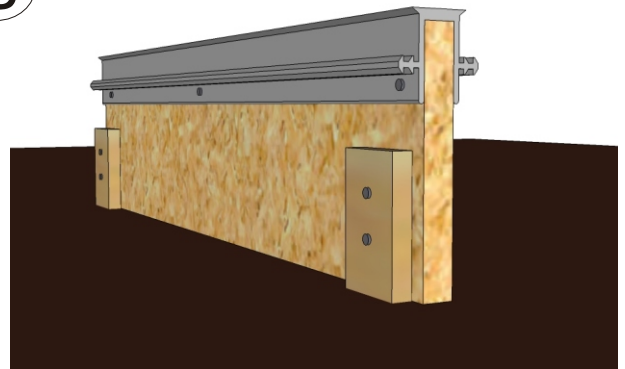

C

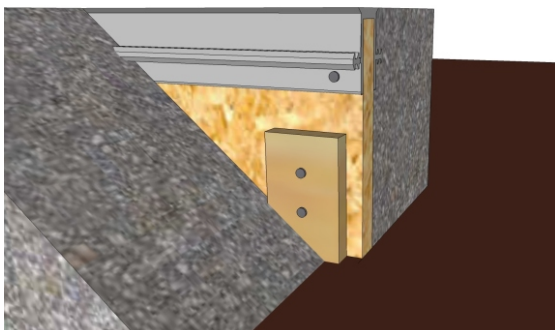

D

