

Whether it is high trafficked areas for fork lifts, thresholds or cold storage, the solution to joint-spalling is reinforcement with QuicDiamond™ Edge.

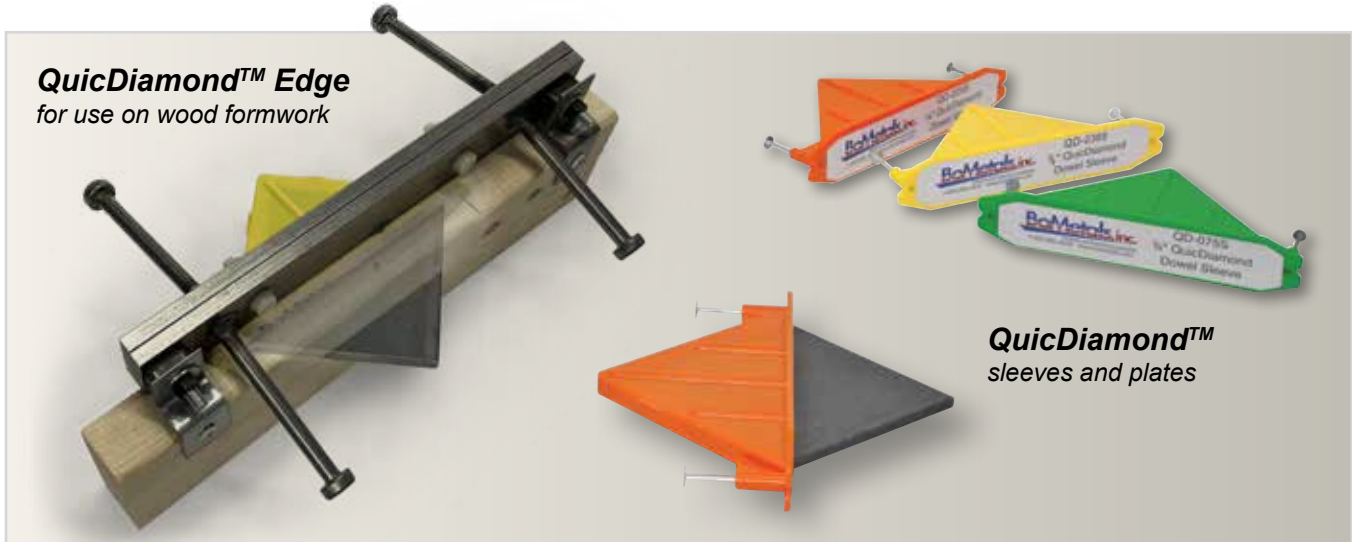

Use QuicDiamond™ Edge for new construction joints...

It provides the confidence that transitions are precise, smooth, and even. Allied with our QuicDiamond™ load transfer system, contractors can know when the job is done, it is precise and will remain this way.

Nothing else stands up better to the abuse of highly trafficked, fast paced areas, where fork lifts constantly travel over construction joints. The design of QuicDiamond™ Edge allows for the needed movement associated with expansion and contraction. Each side of the joint is protected by a 1.5" x 3/8" steel plate protecting the otherwise exposed concrete edge and is designed to accept joint filler for increased function.

The smooth solid transition not only protects the floor but it also protects the wheels that travel over it and thereby can reduce maintenance on the equipment used within the space. The easy to install QuicDiamond™ Edge is affixed to the top of wood form boards.

BENEFITS OF USE

- Avoid inconvenient and costly repairs
- The investment of QuicDiamond™ Edge during construction extends the life cycle and saves money over time
- Allows for expansion and contraction protecting both edges of the joint transition.

Two parallel rolled steel plates are attached to each other with nylon bolts that will remain in place during installation. Anchor studs occur every 9" OC on each side of the joint. Once installed and contraction occurs the nylon bolts no longer serve a purpose and are designed to break away during the contraction process. This allows the necessary travel required for each metal plate to stay with slab to which it is anchored.

Part No.	Description	Qty/Ea	Unit of Measure
QDE-1500144	QuicDiamond™ Edge 1.5"x 12', with JF and Z-Brackets – offset	1	12 foot section

FORM & PLACE CONCRETE

STEP 1:

QuicDiamond™ Edge assemblies should be placed according to jobsite/engineering plans. Height should be adjusted using the Form Stake which is attached to 2"x lumber form, (+ 1/4") to finished floor elevation. Care should be taken to place the QuicDiamonds no closer than 6" to any joint intersection.

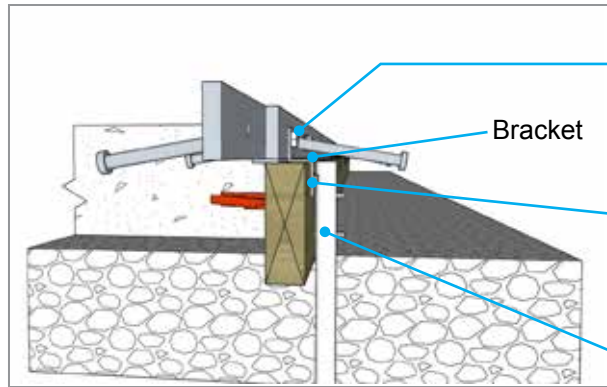

- Steel nut combines assembly bolt to hold mounting bracket (non-continuous)
- Bracket
- Mounting bracket is secured to form at the top and back with two 8d duplex nails per bracket
- Form Stake

STEP 2:

QuicDiamond™ Edge should always be plumb and parallel during placement. Place concrete on side with QuicDiamonds.

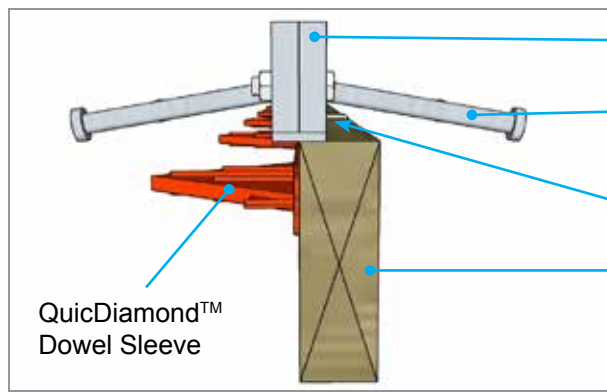

- QuicEdge (2) 1 1/2" x 3/8" continuous steel
- 4" x 3/8" Headed Stud @ 9" o/c
- Stitch Weld - one side
- Set 2X Lumber form 1 - 3/4" (± 1/4") adjust final elevation when QuicDiamond™ Edge is attached.
- QuicDiamond™ Dowel Sleeve

STRIP FORM AND INSERT QUICDIAMOND™ PLATE

STEP 3:

Place concrete as normal, taking care to consolidate with vibration. Do not disturb QuicDiamond™ sleeve. Remove wood form and insert QuicDiamond™ Plate.

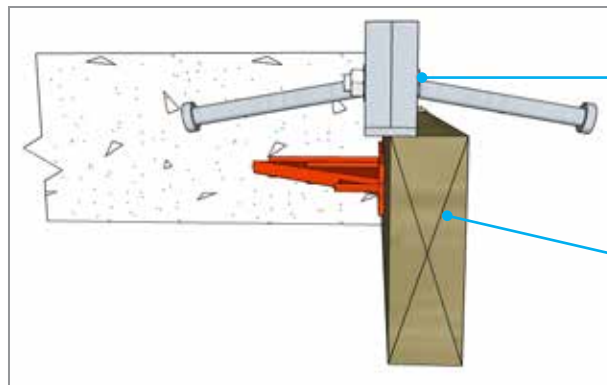

- Remove shipping bracket spacer to facilitate form removal Nylon assembly holds second bar in place during second slab cast.
- Remove form stake and form.

PLACE SECOND CONCRETE SLAB

STEP 4:

Place concrete for 2nd pour and consolidate. QuicDiamond™ Edge is secured to concrete slab and is ready for curing.

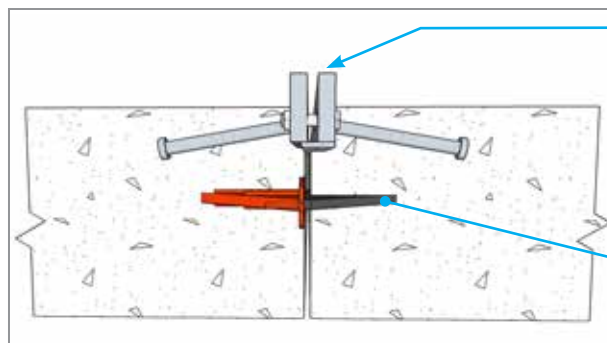

- Remove any concrete paste from top of bars during finishing
- Nylon assembly threads strip as concrete contracts and joints open
- Insert QuicDiamond™ Plate

Note: Standard length is 12' with 4 1/2" offset.