

PRODUCT DATA SHEET
3/4" QuicDiamond Flat Plate

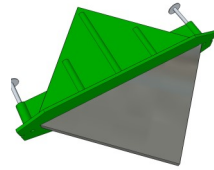

QuicDiamond System Info	Sleeve	Plate
Product Code	QD-075S	QD-075P
Size	3/4"	3/8"x4 1/2"x4 1/2"
Material	ABS	A-36 Steel

WHERE TO USE QuicDiamonds:
QuicDiamond System is used in slab-on grade joints to provide effective load transfer .

Based on spacing recommendation in conformance with ACI 360-10		
Slab Thickness	QuicDiamond Dimensions	Spacing (Center to Center)
9"-12"	3/4"x4 1/2"x4 1/2"	18"

Note: Values are based on a maximum joint opening of 0.20"

INSTALLATION

Preparation

During progress of work all QuicDiamonds shall be protected from damage and should be free of oil, dirt and concrete spatter.

Location & Placement of QuicDiamond

1. Set up formwork.
2. Locate and mark with chalk line at specified location but usually at center of slab but at least 2 1/4" from top of slab.
3. Align QuicDiamond Sleeve at specified location.
4. Use preset nails to attach QuicDiamond Sleeve to formwork. Figure A.
5. Place all reinforcement needed.
6. Pour and finish concrete per ACI specification. Pour at least 18 inches from QuicDiamond System. Figure B.
7. Maneuver the concrete around the QuicDiamond System, vibrate & finish concrete.
8. After concrete cures, remove formwork with base & bend nails away from plate.
9. Place plate into sleeve. Figure C.
10. Place all reinforcement needed.
11. Pour and finish concrete per ACI specification. Pour at least 18 inches from QuicDiamond System.
12. Maneuver the concrete around the flat plate/rebar, vibrate & finish concrete. Figure D.

INSTALLATION DETAILS

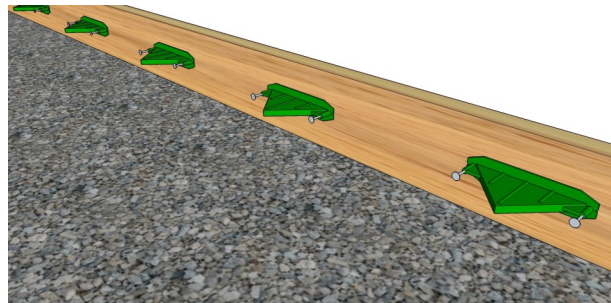

Figure A

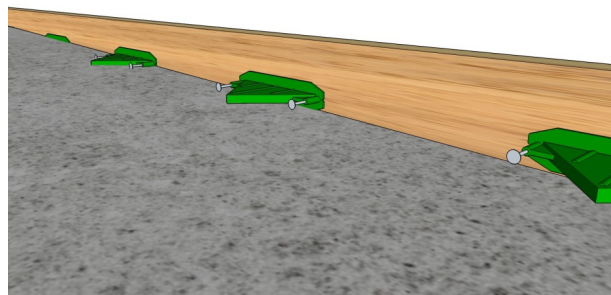

Figure B:

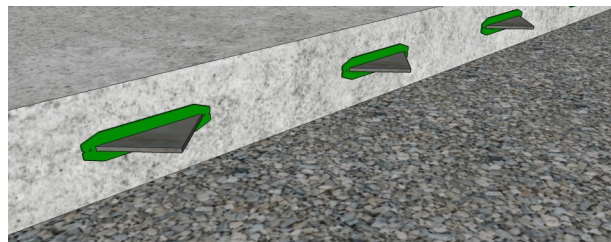

Figure C:

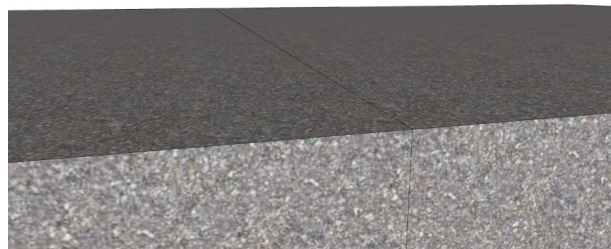

Figure D:

141 Hammond Street
 Carrollton, GA 30117

Phone 770-832-2000 ■ 800-862-4835 ■ FAX 770-832-2095
 Visit our website @ www.bometals.com
 Address email to info@bometals.com

Founded in 1989, BoMetals has become an industry leader in the design and manufacture of concrete and masonry accessories.